

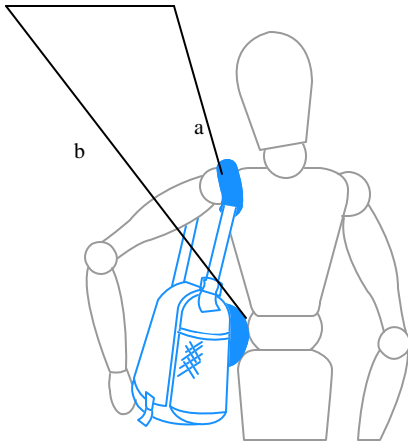

Fitting your shoulder bag properly

Make the shoulder pack your pack by personalizing the fit



Getting the right fit of your AirPacks shoulder bag is very important. When people first try our shoulder bags they immediately notice how much lighter their load feels...but it may also feel a little different.

Our patented Air Technology shifts the weight from the upper back and shoulders to the hip for better support of heavy loads. Follow these simple steps to adjust the bag until it feels the most comfortable.

Step One

Adjust the inflation of the shoulder strap (a) and lumbar support (b), by unplugging the nozzle, letting air out by squeezing the nozzle or adding air with the pump. Do not over-inflate.

Step Two

Load your shoulder pack with weight so that you can fit it directly to your body.

Adjust the shoulder strap so that the lumbar support rests on your hip or small of the back.

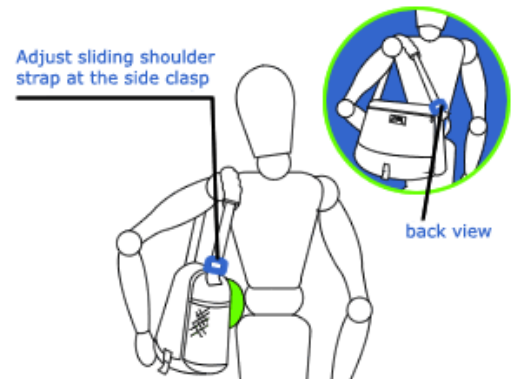

Step Three

Load it up and get going! For pure comfort and no achy shoulders, let the shoulder pack rest on your hips or in the small of your back.



If this is not the most comfortable bag that you have ever worn, call us at 800-310-7383 and we will fit your bag properly.

(See reverse side for properly fitting backpacks)